

RK LUXURIA



Head Office:

House # 179/57, Alto Bella Vista, Sangolda, North-Goa, 403 511
Website: www.rkluxuria.com Email: info@rkluxuria.com

Project Location:

RK Luxuria, Main St. Nagalli Hills Colony,
Dona Paula, Goa - 403 501

Contact No.: +91 **9822 12 58 35**

Disclaimer: The illustrations contained in this brochure are artists impressions hence subject to change and cannot form part of a legal offer or contract





11 INCOMPARABLE FEATURES

1. One Apartment Per Floor.
2. 180° degree uninterrupted view of Miramar Bay.
3. Optimal Light Ventilation to all Rooms.
4. Uncluttered and hidden 50% designated wardrobe areas in all 3 bedrooms.
5. Defined Dining Area with Powder Toilet.
6. Optimal percentage SBUA within the Apartment.
7. Large 6" wide and 10" long Toilet Blocks.
8. Independent/ Detached studio unit for servant at Lower Ground floor for each Apartment.
9. Greenhouse theme exteriors.
10. Independent Caretaker, with Residence at Stilt Level.
11. 2 Car Parks Per Apartment.

CUSTOMISED APARTMENTS



TALK TO US AT **9822125835**



BEST IN CLASS AMENITIES

1. Cultured Marble / Granite flooring in Living.
2. Wooden design flooring in Dining / Kitchen.
3. White Cultured Granite Kitchen Top.
4. Gypsum false ceiling to entire Apartment.
5. 4x4 Italian design tiles to bath walls.
6. Jaguar / Kohler bath fittings.
7. Power Backup.
8. Solar Heater to the entire Building.
9. CCTV in common area, Video door Phone.
10. Fibre Optic/Cat 64 wiring and points at living & all bedrooms, Common Dish Antenna.
11. AC infrastructure copper piping, wiring & water drain at 5 locations in Apartment.
12. 6 passenger Next Gen. Stainless steel finish Elevator with ARD and VVVF drive & Voltage Stabilizer.
13. Glass Entrance to staircase and elevator lobby with RFID Access.
14. Teak Wood Entrance Door & Designer Internal Door.
15. Shoe Rack.

BREATHTAKING **BAY VIEW**



SPACIOUS **LIVING ROOM**

ELEGANT **KITCHEN**





BEDROOMS WITH EXPANSIVE **SEASCAPE**

LARGE **BATHROOM**



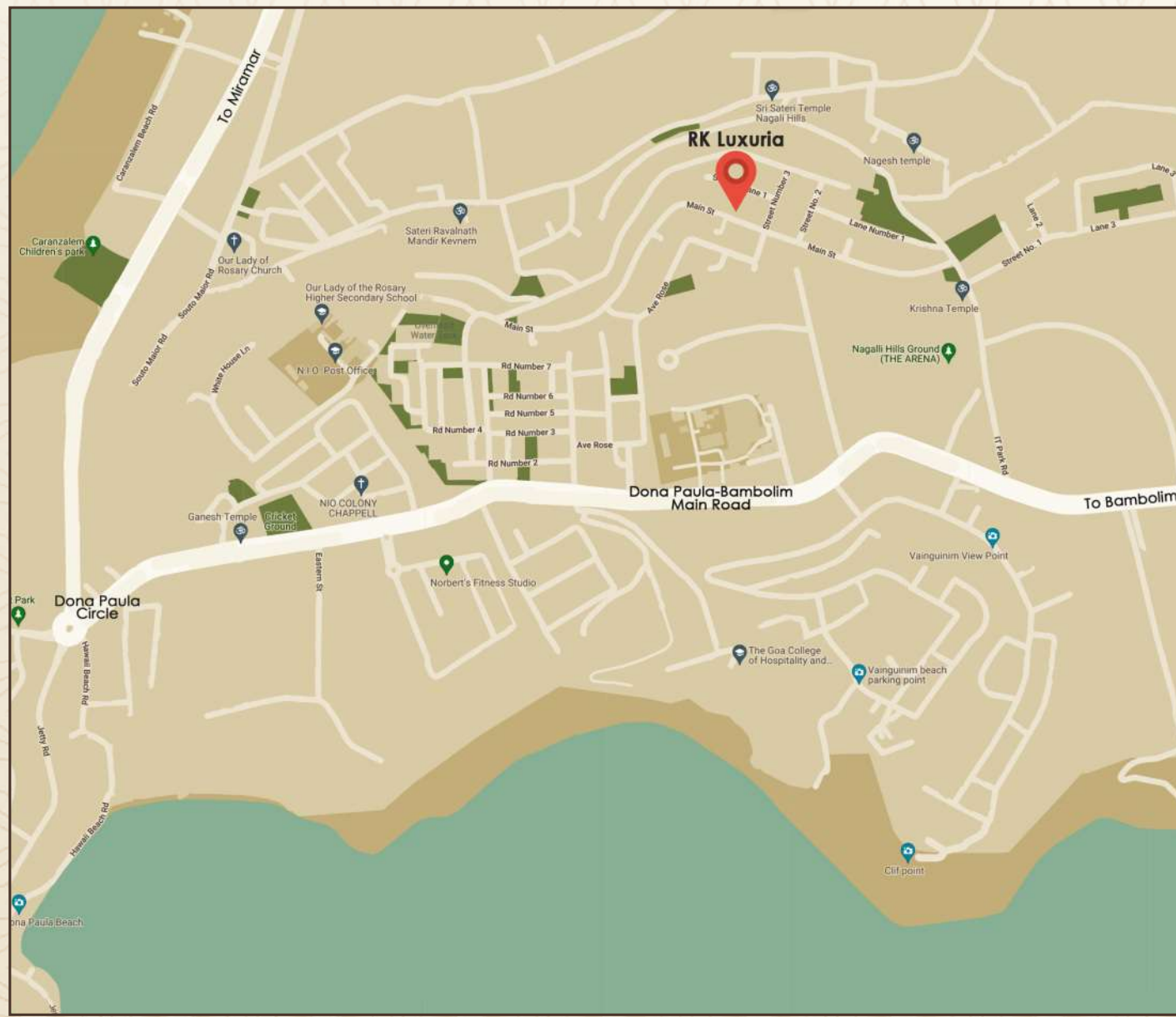

LOCATION ADVANTAGE

1. Elite & Serene "Nagally" Dona Paula.
2. 1 Km from Manipal Hospital and Taleigao.
3. Seamless 4 lane road connectivity to Dona Paula, Miramar, Panaji.
4. 6 minutes drive to Bambolim, Panaji - Margao Nh66 Highway.
5. Ample Availability of Domestic help at Taleigao.

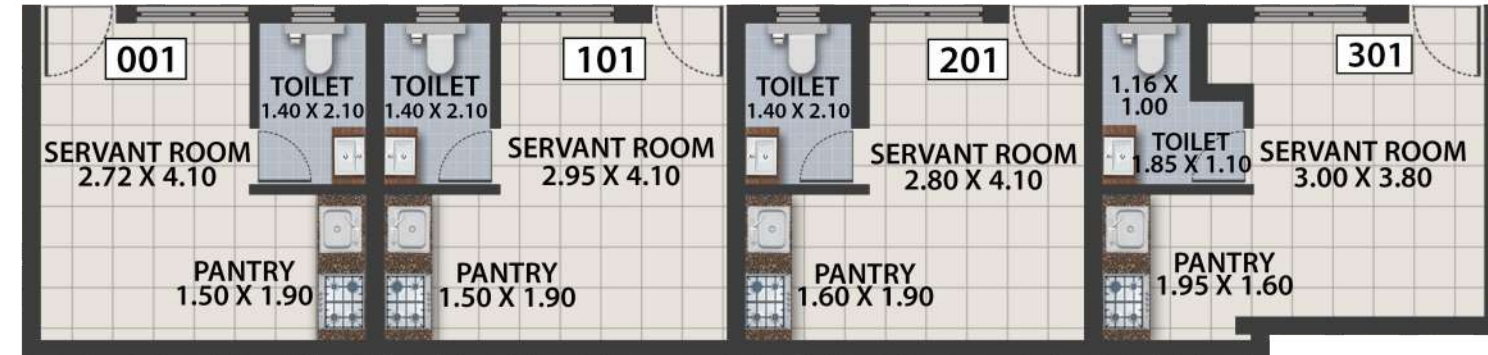

BASEMENT FLOOR PLAN



STILT FLOOR PLAN



UG, FIRST & SECOND FLOOR PLAN



THIRD FLOOR & TERRACE PLAN

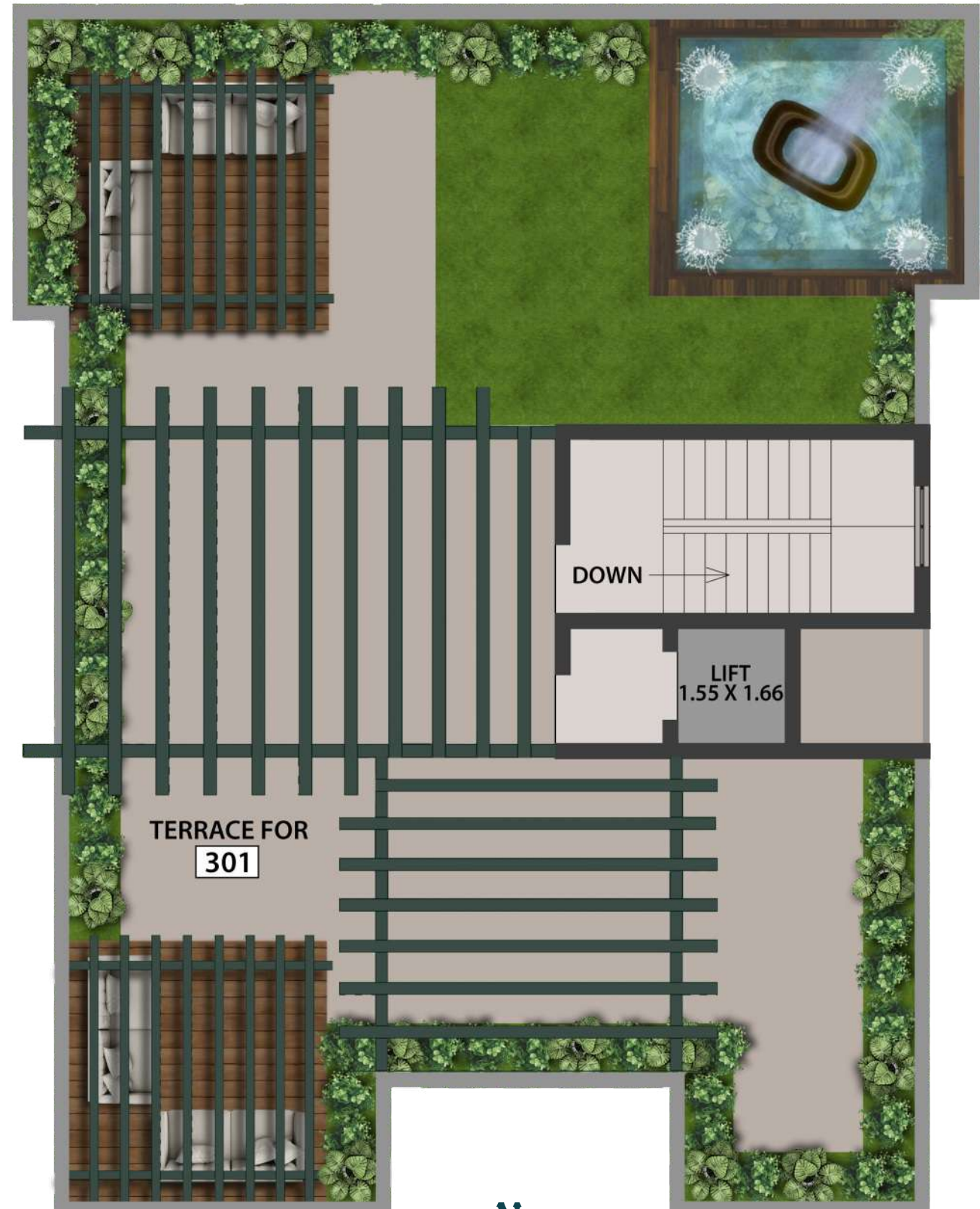

**PRIVATE
TERRACE
FOR #301**

